

FLOORPLAN

Borrower: MEASUREMENT REQUEST

File No.: HIGHLANDPARK-FLRPLN

Property Address: 4904 HIGHLAND PARK COURT

Case No.: LINDA CRAFT & TEAM

City: RALEIGH

State: NC

Zip: 27613

Lender: LINDA CRAFT & TEAM

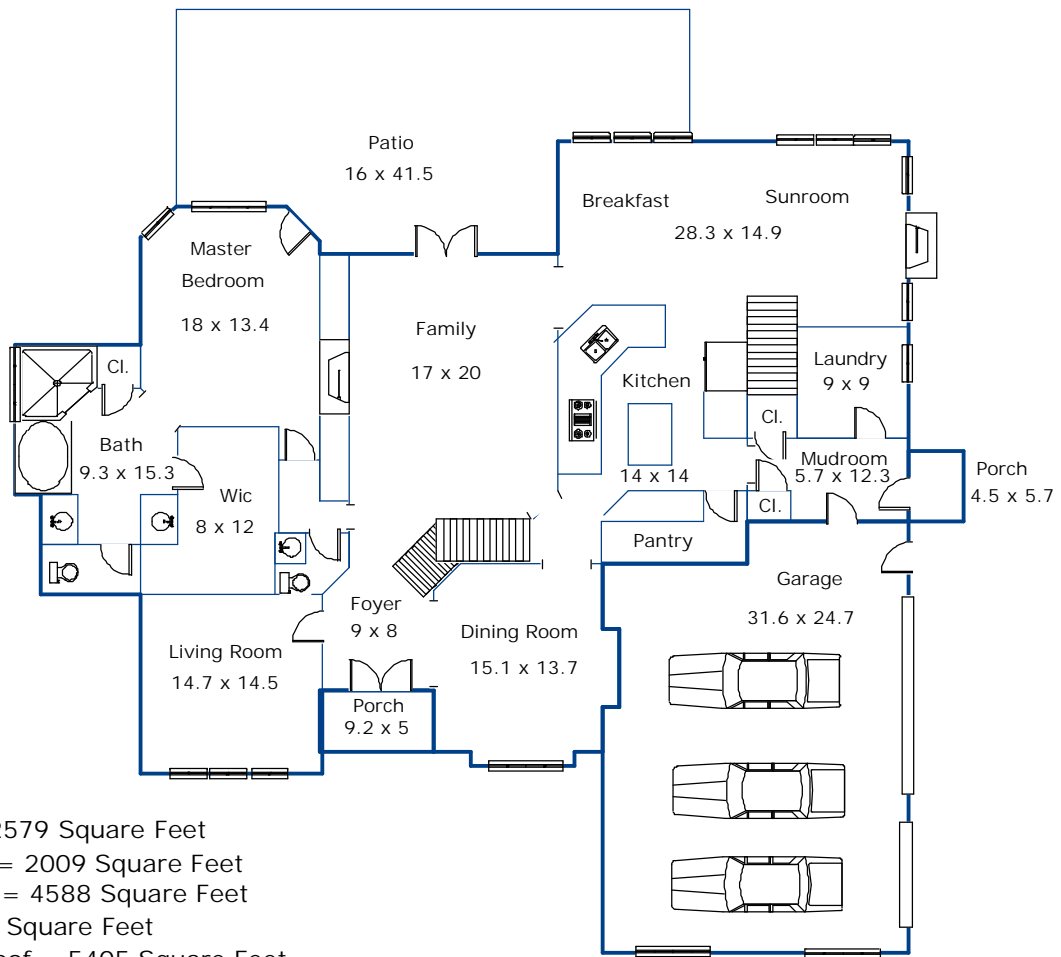

First Floor = 2579 Square Feet
 Second Floor = 2009 Square Feet
 Total Finished = 4588 Square Feet
 Garage = 817 Square Feet
 Total Under Roof = 5405 Square Feet

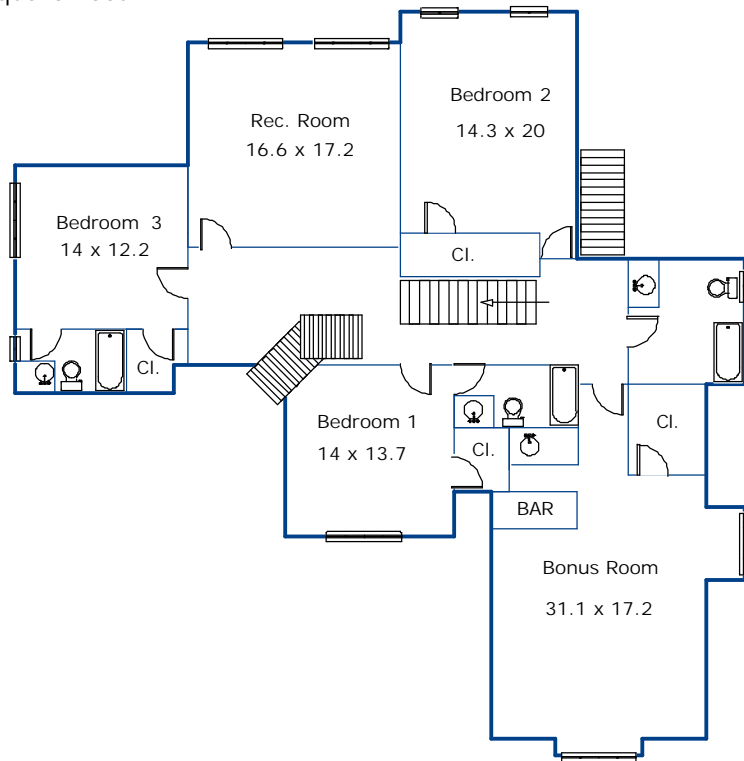

Sketch by Apex Medina™

FLOORPLAN

Borrower: MEASUREMENT REQUEST	File No.: HIGHLANDPARK-FLRPLN
Property Address: 4904 HIGHLAND PARK COURT	Case No.: LINDA CRAFT & TEAM
City: RALEIGH	State: NC
Lender: LINDA CRAFT & TEAM	Zip: 27613

AREA CALCULATIONS SUMMARY			
Code	Description	Net Size	Net Totals
GLA1	First Floor	2579.3	
	second floor	2008.9	
	Porch	46.0	
	Porch	25.6	4659.8
GAR	Garage	816.5	816.5
Net LIVABLE Area		(rounded)	4660

LIVING AREA BREAKDOWN			
Breakdown			Subtotals
First Floor			
0.5 x	0.0 x	12.2	0.0
	7.3 x	62.1	455.6
	3.4 x	57.2	194.5
	2.2 x	70.2	154.4
	72.3 x	12.2	879.4
0.5 x	2.9 x	2.4	3.5
	0.3 x	14.2	3.8
	1.1 x	14.5	15.9
	9.1 x	28.3	257.5
	2.5 x	45.5	113.8
	8.9 x	2.4	21.7
0.5 x	0.3 x	0.3	0.0
	38.7 x	5.0	193.5
	2.8 x	37.4	104.7
0.5 x	2.4 x	2.4	3.0
	3.7 x	13.7	50.7
	1.3 x	15.0	19.5
	6.7 x	14.7	98.5
	1.1 x	8.4	9.2
second floor			
	45.5 x	7.5	341.3
	10.0 x	31.5	315.0
15 Items Not Listed			1424.3
36 Items			(rounded) 4660

First Floor		GLA1	
0.5 x	0.0 x	12.2 =	0.0
	7.3 x	62.1 =	455.6
	3.4 x	57.2 =	194.5
	2.2 x	70.2 =	154.4
	72.3 x	12.2 =	879.4
0.5 x	2.9 x	2.4 =	3.5
	0.3 x	14.2 =	3.8
	1.1 x	14.5 =	15.9
	9.1 x	28.3 =	257.5
	2.5 x	45.5 =	113.8
	8.9 x	2.4 =	21.7
0.5 x	0.3 x	0.3 =	0.0
	38.7 x	5.0 =	193.5
	2.8 x	37.4 =	104.7
0.5 x	2.4 x	2.4 =	3.0
	3.7 x	13.7 =	50.7
	1.3 x	15.0 =	19.5
	6.7 x	14.7 =	98.5
	1.1 x	8.4 =	9.2

Garage		GAR	
24.7 x	5.3 =	130.9	
3.4 x	13.0 =	44.2	
20.0 x	24.7 =	494.0	
6.3 x	23.4 =	147.4	

Area total (rounded) = 2579

Area total (rounded) = 817

second floor		GLA1	
	45.5 x	7.5 =	341.3
	10.0 x	31.5 =	315.0
	59.0 x	8.6 =	507.4
	2.5 x	14.3 =	35.8
	0.8 x	33.3 =	26.6
	1.6 x	34.8 =	55.7
	2.3 x	12.8 =	29.4
	20.5 x	5.9 =	121.0
	1.3 x	17.4 =	22.6
	3.7 x	13.7 =	50.7
	7.9 x	34.1 =	269.4
0.5 x	0.8 x	0.8 =	0.3
0.5 x	1.6 x	1.6 =	1.3
	12.8 x	17.4 =	222.7
	1.4 x	7.0 =	9.8

Porch		GLA1	
9.2 x	5.0 =	46.0	

Area total (rounded) = 2009

Area total (rounded) = 46

FLOORPLAN

Borrower: MEASUREMENT REQUEST

File No.: HIGHLANDPARK-FLRPLN

Property Address: 4904 HIGHLAND PARK COURT

Case No.: LINDA CRAFT & TEAM

City: RALEIGH

State: NC

Zip: 27613

Lender: LINDA CRAFT & TEAM

Porch

GLA1

$$4.5 \times 5.7 = 25.6$$

$$\text{Area total (rounded)} = 26$$