

FLOORPLAN

Borrower: MEASUREMENT REQUEST

File No.: MABRYRD-FLRPLN

Property Address: 1044 MABRY ROAD

Case No.: LINDA CRAFT & TEAM

City: ANGIER

State: NC

Zip: 27501

Lender: LINDA CRAFT & TEAM

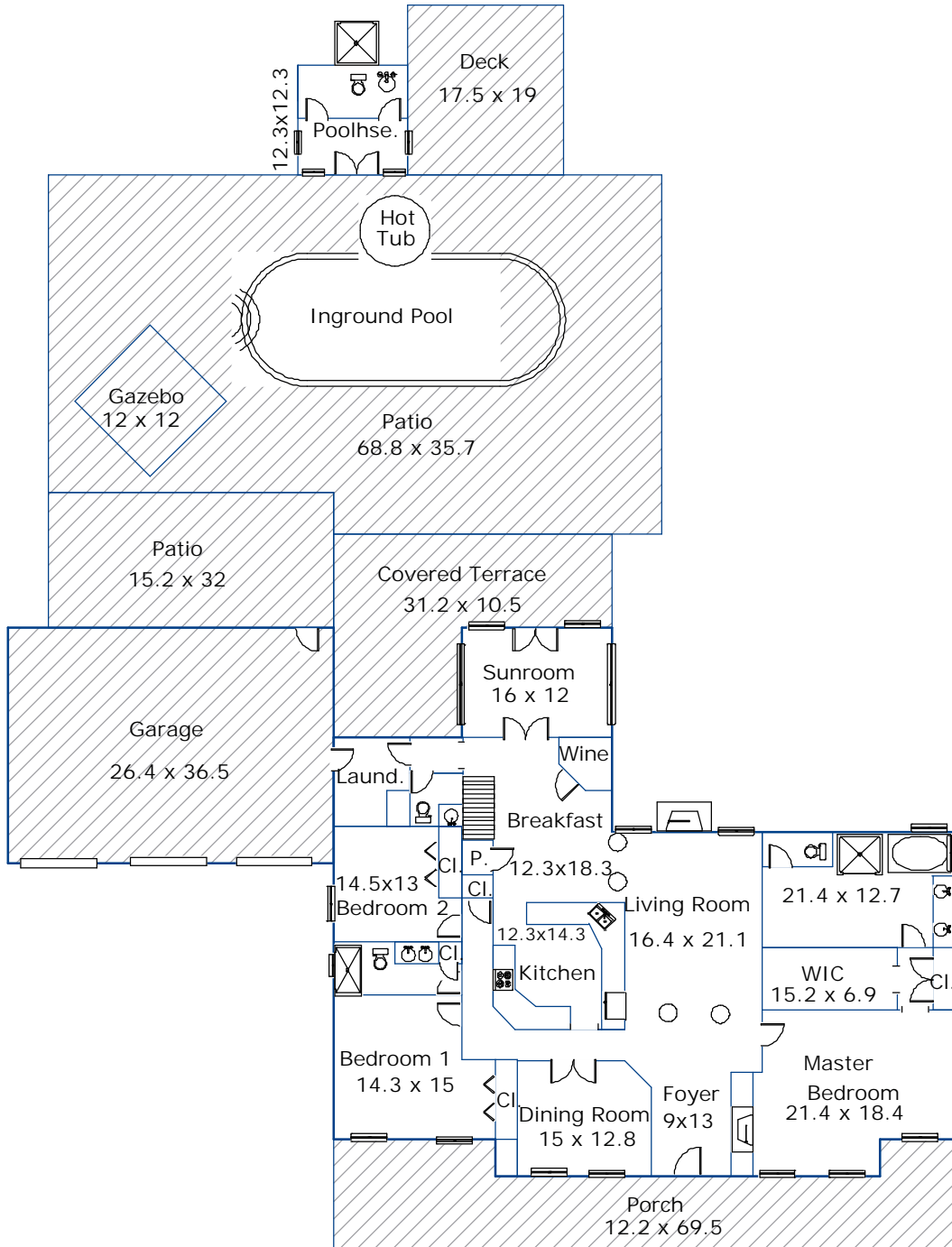

FIRST FLOOR = 3120 SQUARE FEET
 SECOND FLOOR = 1896 SQUARE FEET
 TOTAL FINISHED = 5016 SQUARE FEET
 ATTACHED Garage = 964 SQUARE FEET
 DeTACHED GARAGE 1 = 1608 SQUARE FEET
 DeTACHED Office = 312 SQUARE FEET
 DeTACHED GARAGE 2 = 747 SQUARE FEET
 LEAN-TO = 315 SQUARE FEET

Sketch by Apex Medina™

FLOORPLAN

Borrower: MEASUREMENT REQUEST

File No.: MABRYRD-FLRPLN

Property Address: 1044 MABRY ROAD

Case No.: LINDA CRAFT & TEAM

City: ANGIER

State: NC

Zip: 27501

Lender: LINDA CRAFT & TEAM

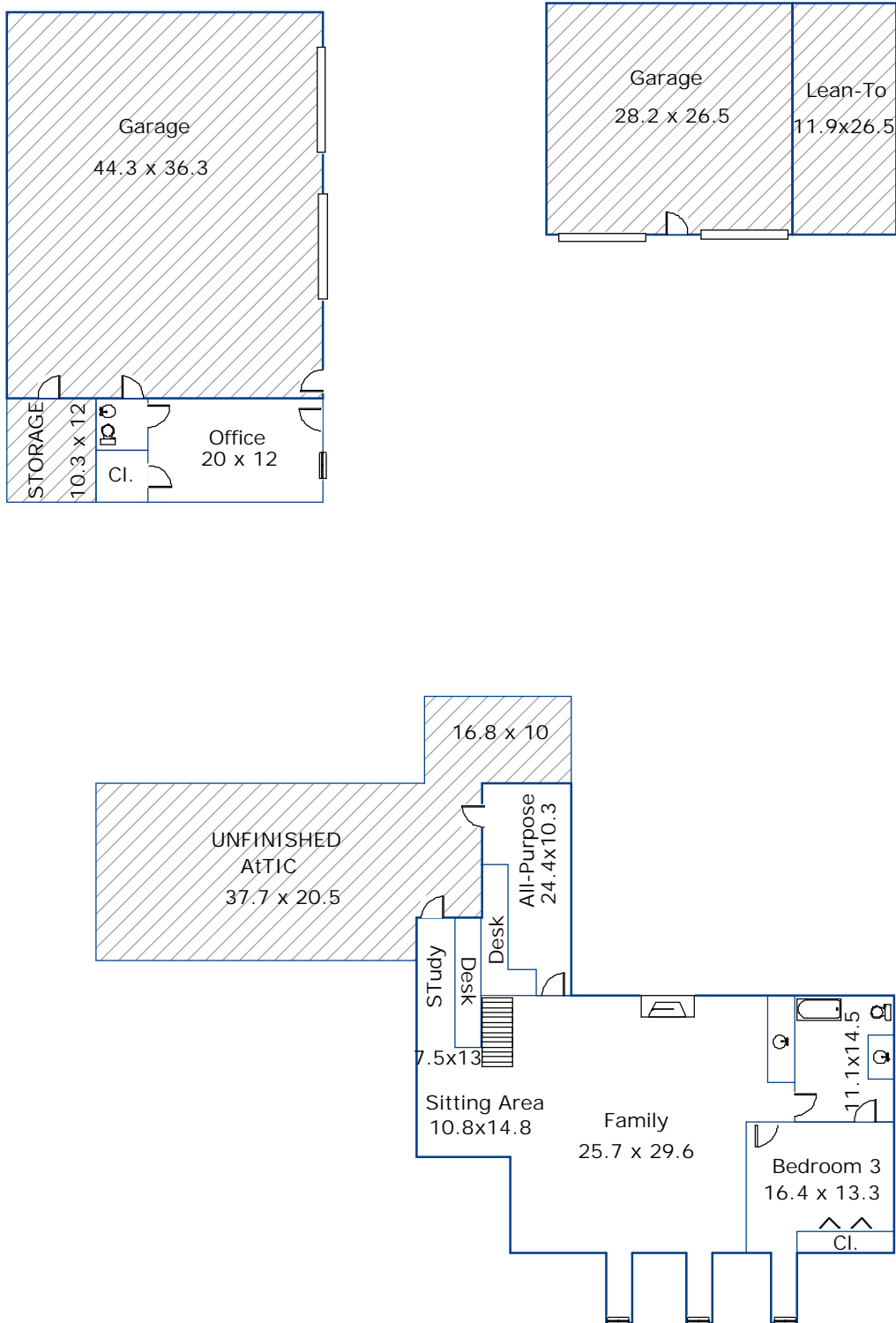

Sketch by Apex Medina™

FLOORPLAN

Borrower: MEASUREMENT REQUEST	File No.: MABRYRD-FLRPLN
Property Address: 1044 MABRY ROAD	Case No.: LINDA CRAFT & TEAM
City: ANGIER	State: NC
Lender: LINDA CRAFT & TEAM	Zip: 27501

AREA CALCULATIONS SUMMARY			
Code	Description	Net Size	Net Totals
GLA1	First Floor	3120.4	3120.4
GAR	Garage	963.6	963.6
OTH	porch	670.8	
	Covered Terrace	503.5	
	Patio	486.4	
	Patio	2629.1	
	POOLHOUSE	151.3	
	Deck	332.5	
	Cabana	144.0	4917.6
GLA1	second floor	1896.0	1896.0
GAR	Garage	747.3	
	Garage	315.3	
	Garage	1608.1	2670.7
OTH	ATTIC	1032.2	
	OFFICE	312.0	
	Storage	123.6	1467.8
Net LIVABLE Area		(rounded)	5016

LIVING AREA BREAKDOWN			
Breakdown			Subtotals
First Floor			
	43.2	x 4.1	177.1
	12.3	x 16.9	207.9
	10.6	x 31.2	330.7
	34.6	x 69.5	2404.7
second floor			
	17.8	x 9.0	160.2
	15.4	x 10.3	158.6
	54.9	x 18.5	1015.7
	8.0	x 3.0	24.0
	8.0	x 3.0	24.0
	8.0	x 3.0	24.0
	11.1	x 44.1	489.5
11 Items			(rounded) 5016

First Floor	GLA1
43.2 x 4.1	= 177.1
12.3 x 16.9	= 207.9
10.6 x 31.2	= 330.7
34.6 x 69.5	= 2404.7

porch	OTH
18.1 x 4.1	= 74.2
69.5 x 8.1	= 563.0
4.1 x 8.2	= 33.6

Area total (rounded) = 3120

Area total (rounded) = 671

Covered Terrace	OTH
14.3 x 12.3	= 175.9
31.2 x 10.5	= 327.6

Garage	GAR
36.5 x 26.4	= 963.6

Area total (rounded) = 503

Area total (rounded) = 964

FLOORPLAN

Borrower: MEASUREMENT REQUEST

File No.: MABRYRD-FLRPLN

Property Address: 1044 MABRY ROAD

Case No.: LINDA CRAFT & TEAM

City: ANGIER

State: NC

Zip: 27501

Lender: LINDA CRAFT & TEAM

Patio				OTH
	32.0	x	15.2	= 486.4

Area total (rounded) = 486

Patio				OTH
	35.7	x	68.8	= 2456.2
	4.7	x	36.8	= 173.0

Area total (rounded) = 2629

POOLHOUSE				OTH
	12.3	x	12.3	= 151.3

Area total (rounded) = 151

Deck				OTH
	19.0	x	17.5	= 332.5

Area total (rounded) = 333

Cabana				OTH
	0.5	x	8.5	x 8.5 = 36.0
	0.5	x	8.5	x 8.5 = 36.0
	0.5	x	8.5	x 8.5 = 36.0
	0.5	x	8.5	x 8.5 = 36.0

Area total (rounded) = 144

second floor				GLA1
	17.8	x	9.0	= 160.2
	15.4	x	10.3	= 158.6
	54.9	x	18.5	= 1015.7
	8.0	x	3.0	= 24.0
	8.0	x	3.0	= 24.0
	8.0	x	3.0	= 24.0
	11.1	x	44.1	= 489.5

Area total (rounded) = 1896

FLOORPLAN

Borrower: MEASUREMENT REQUEST

File No.: MABRYRD-FLRPLN

Property Address: 1044 MABRY ROAD

Case No.: LINDA CRAFT & TEAM

City: ANGIER

State: NC

Zip: 27501

Lender: LINDA CRAFT & TEAM

ATTIC

OTH

44.2 x 15.4 = 680.7
10.0 x 16.8 = 168.0
5.0 x 36.7 = 183.5

Area total (rounded) = 1032

Garage

GAR

28.2 x 26.5 = 747.3

Area total (rounded) = 747

Garage

GAR

11.9 x 26.5 = 315.3

Area total (rounded) = 315

Garage

GAR

36.3 x 44.3 = 1608.1

Area total (rounded) = 1608

OFFICE

OTH

12.0 x 26.0 = 312.0

Area total (rounded) = 312

Storage

OTH

10.3 x 12.0 = 123.6

Area total (rounded) = 124